

CONTRA COSTA COLLEGE
OPERATIONS COUNCIL COMMITTEE
Monday, September 25, 2017
9:00-10:00 a.m., Room SAB-211

Minutes

Committee Members: Ken Sherwood (chair), Beth Goehring, Megan Kinney, Lilly Harper, Brian Williams, Dennis Franco, Vicki Ferguson, Cody Poehnelt (student). Ex-officio: Lt. Thomas Holt, James Eyestone, Darlene Poe, Bruce King, Brandy Howard, Jason Berner.

Present: Ken Sherwood, Beth Goehring, James Eyestone, Bruce King, Megan Kinney, Vicki Ferguson, Lilly Harper, Brian Williams, Lt., Darlene Poe, Jason Berner and Lorena Cortez (taking notes)

Guest: Travis Hiner

Meeting called to order at 9:05 a.m.

I. **Approval of Current Agenda**

Brian Williams moved to approve the agenda. Vicki Ferguson seconded the motion. The agenda was unanimously approved.

II. **Approval of September 11, 2017 Minutes**

Lilly Harper moved to approve the minutes with minor correction to reflect Jason Berner as a non-voting member of Operations Council. Brian Williams seconded the motion. The minutes were unanimously approved.

III. **Action items**

A. Archway Location and Veneer

Beth Goehring and Ken Sherwood presented the archway designs and the proposed locations. The archway engineer noted that the location chosen (foot bridge) to install the archway posed a few issues. The foot bridge entrance location pathway is cluttered by trees, safety pillars and the CCC sign. Also, the archway would need to be installed diagonally to the foot bridge entrance (see foot bridge diagram). Additionally, installing the archway by the foot bridge entrance will increase cost due to the electrical work. Upon the concerns shared by the engineer, a second location for the archway was proposed; the roundabout island located at the main entrance of the college (see round about diagram). The roundabout location would require relocating the Contra Costa College sign, along with some landscaping work. It would also allow for a larger, more picturesque archway at a lower cost of work than the foot bridge entrance. The committee members decided to do a site visit of the proposed archway locations before making a decision.

The committee members discussed the pros and cons of both locations. The primary concern with the roundabout location was that the archway would not be utilized by people to walk under, unless pedestrian crosswalks were installed. The committee members proposed two

additional archway locations: the stairs at the end of the foot bridge entrance and the pathway between the Student & Administration building (SAB) and the lamppost by the creek landscape. Installing the archway at the stairs would be cluttered by the hand rails. Installing the archway between SAB and the lamppost would require the archway to be tall enough to allow for emergency vehicles to pass through.

The committee members recommended for Ken Sherwood to report back to the engineer the two new proposed locations. The engineer will provide a report on the work required to install the archway in the proposed locations, this will be shared with the committee.

IV. Information/Discussion Items

None.

V. Adjournment

The meeting was adjourned at 9:56 a.m.

SITE PLAN

SCALE: 1" = 10' ±

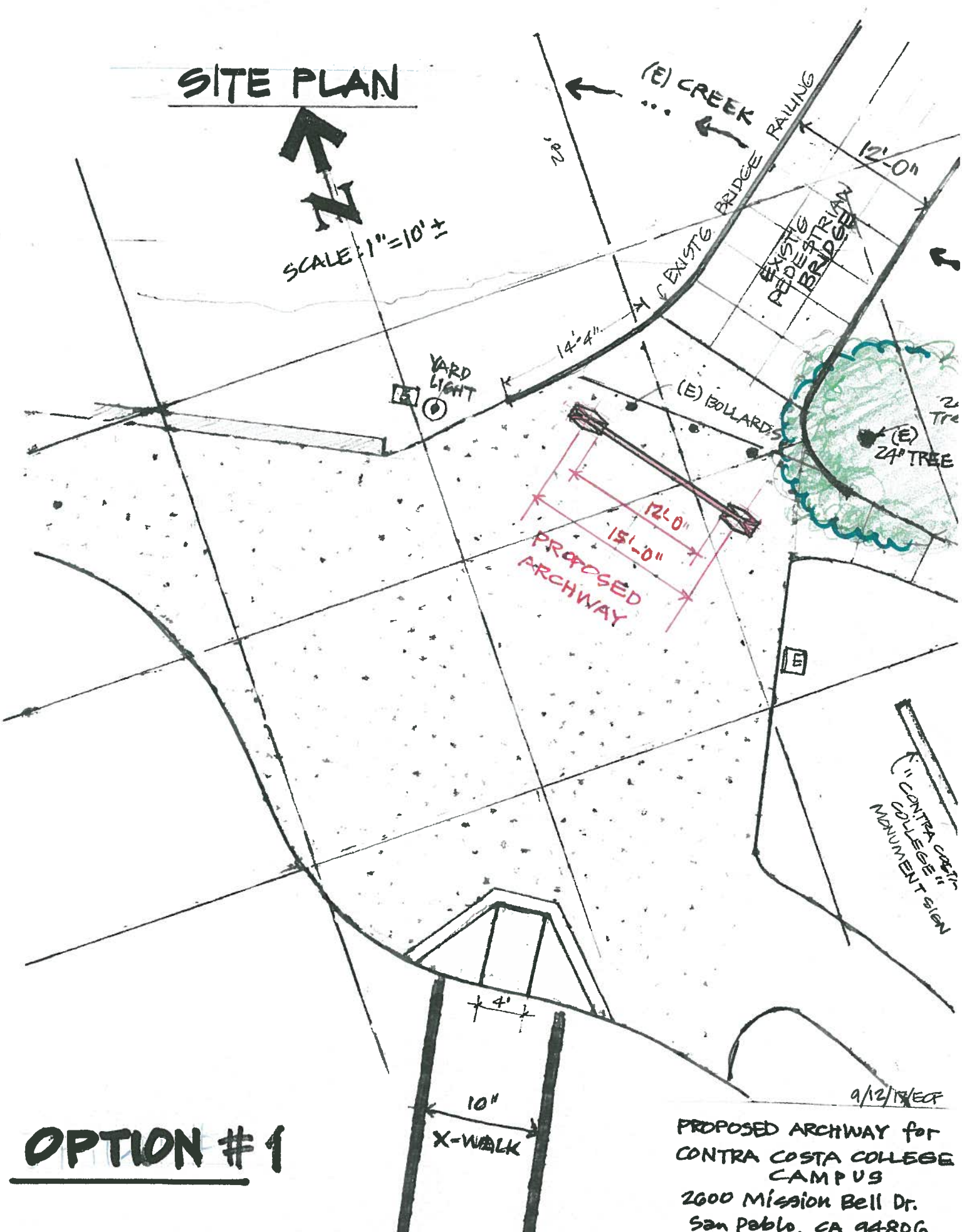

OPTION # 1

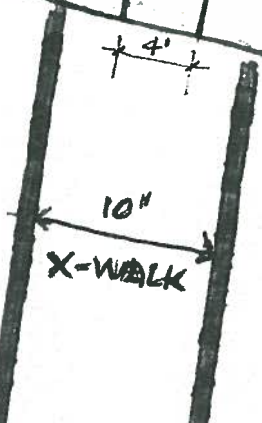

9/12/19/ECF
 PROPOSED ARCHWAY for
 CONTRA COSTA COLLEGE
 CAMPUS
 2600 Mission Bell Dr.
 San Pablo, CA 94806

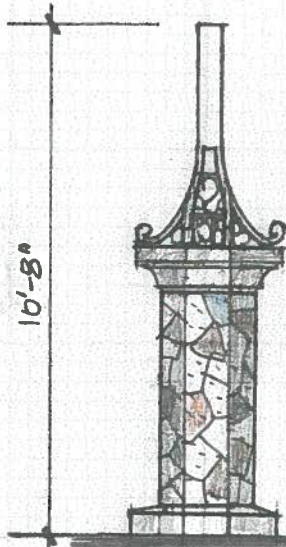
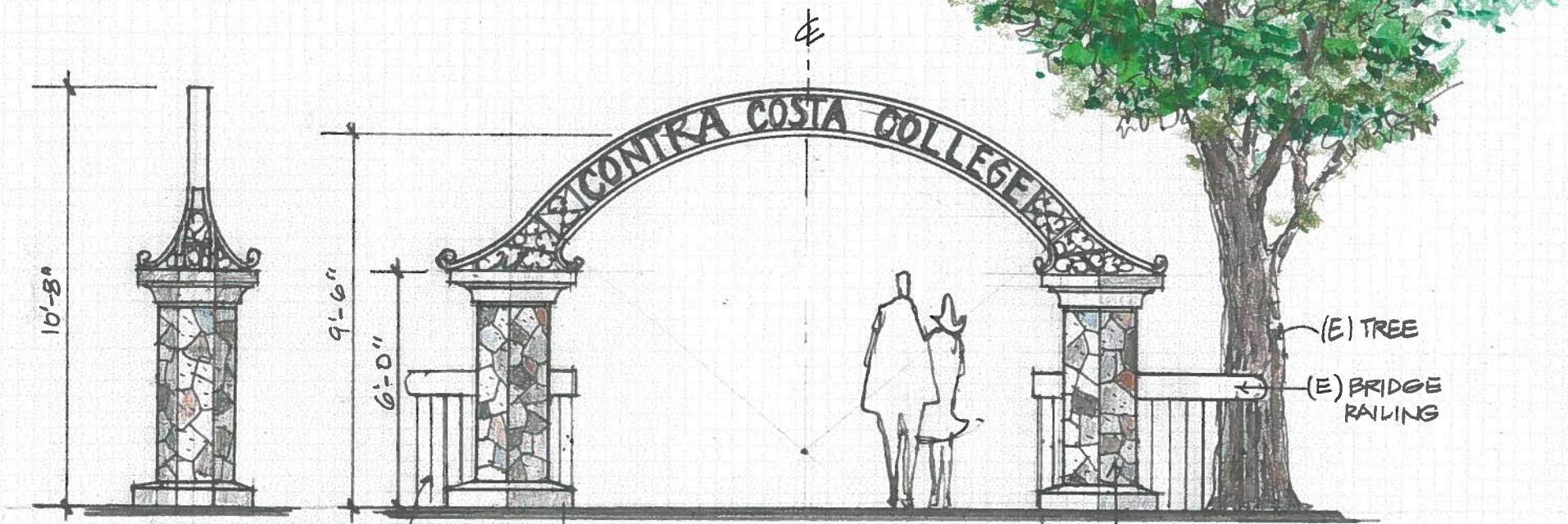

END VIEW



EXIST'G. BRIDGE RAILING

12'-0"
EXIST'G. BRIDGE WIDTH

CULTURED STONE VENEER

FRONT VIEW
SCALE: 1/4" = 1'-0"

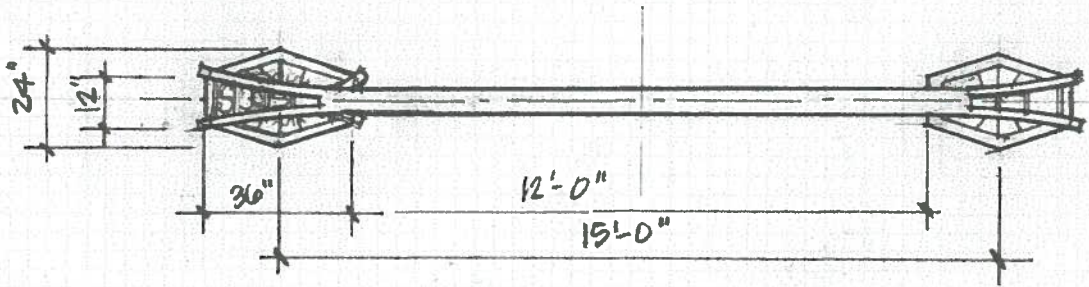

TOP VIEW
SCALE: 1/4" = 1'-0"

OPTION # 1 WITH STONE VENEER

9/12/17/ECF
 PROPOSED ARCHWAY
 FOR CONTRA COSTA COLLEGE
 CAMPUS

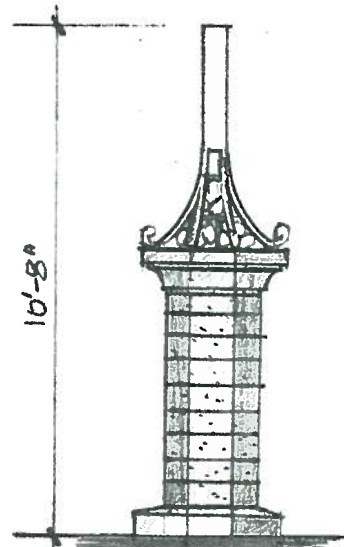

END VIEW

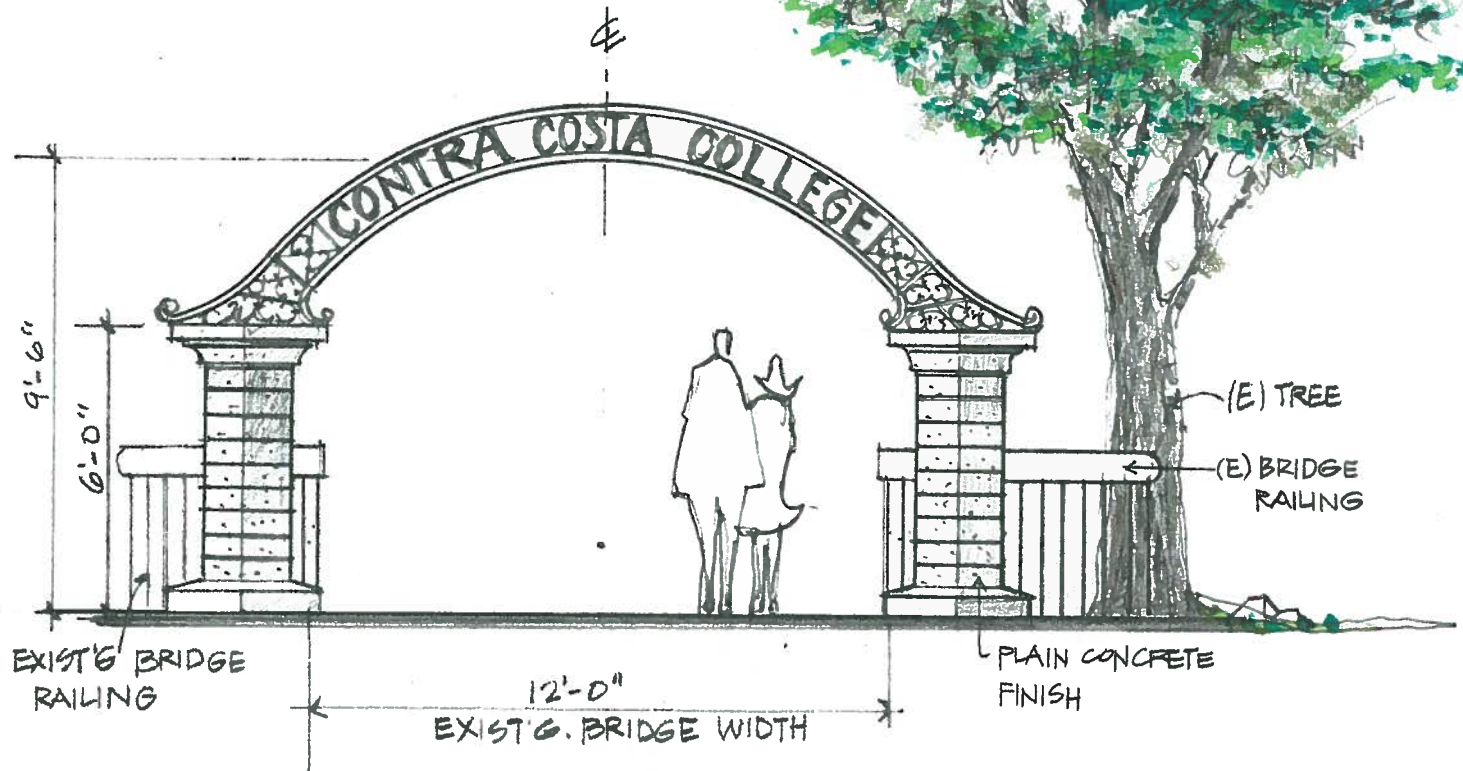

FRONT VIEW
SCALE: 1/4" = 1'-0"

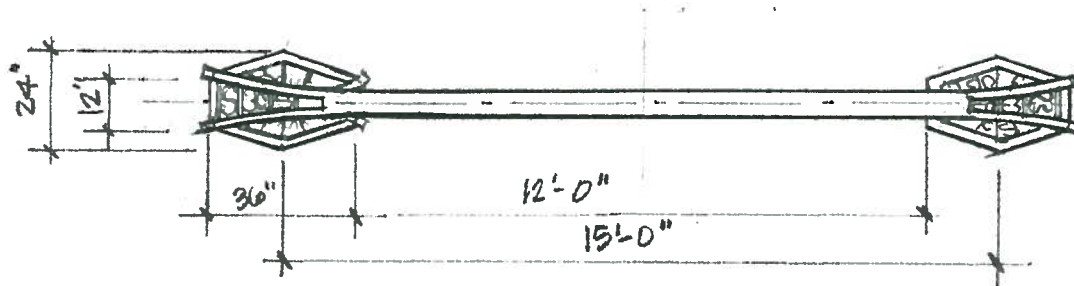

TOP VIEW
SCALE: 1/4" = 1'-0"

OPTION # 1 WITH CONCRETE FINISH

9/12/17/ECF
 PROPOSED ARCHWAY
 for CONTRA COSTA COLLEGE
 CAMPUS
 2000 MISSION BELL DR.
 SAN PABLO, CA 94806

SITE PLAN

SCALE: 1" = 10' ±

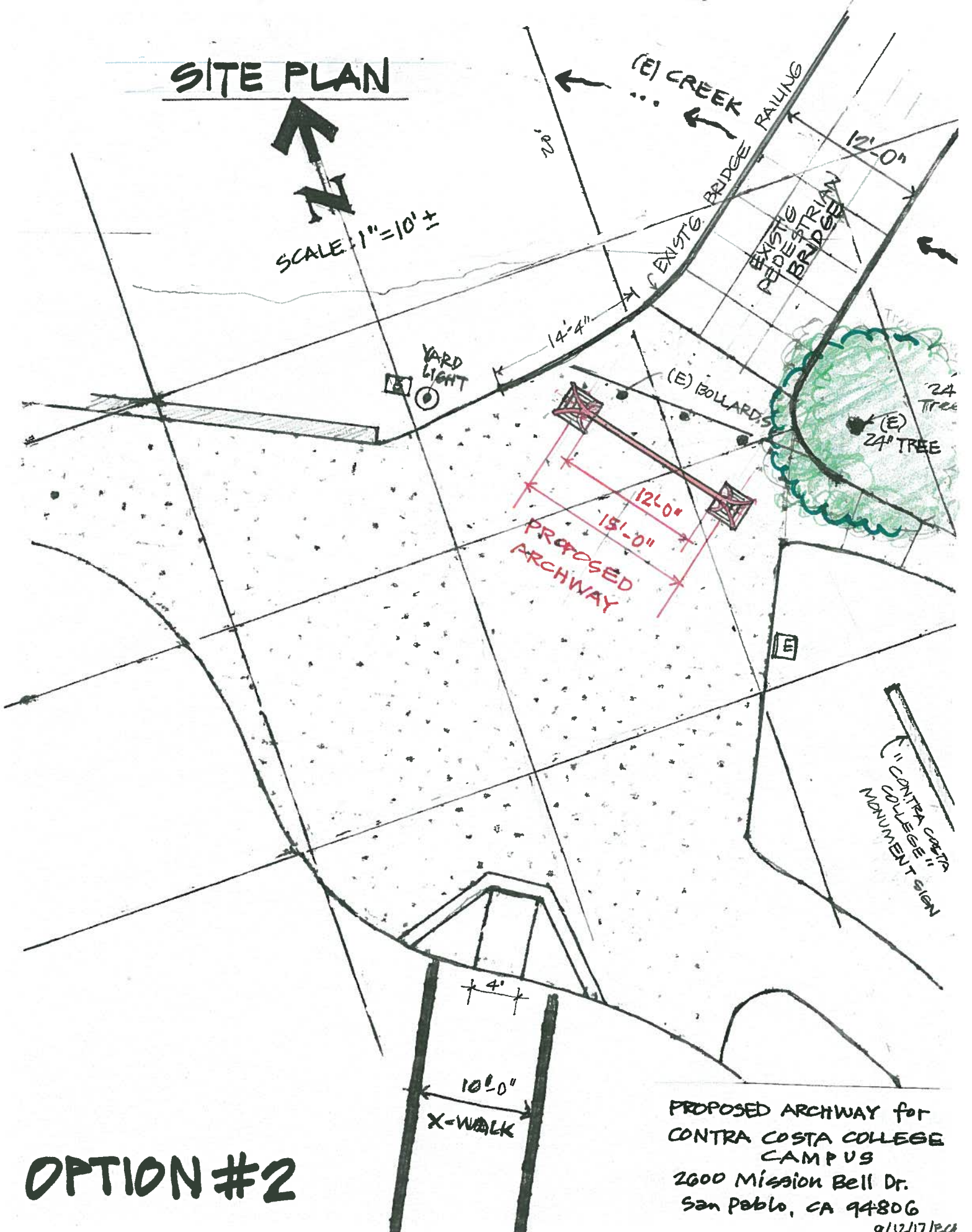

OPTION #2

PROPOSED ARCHWAY for
 CONTRA COSTA COLLEGE
 CAMPUS
 2600 Mission Bell Dr.
 San Pablo, CA 94806
 9/12/17/201

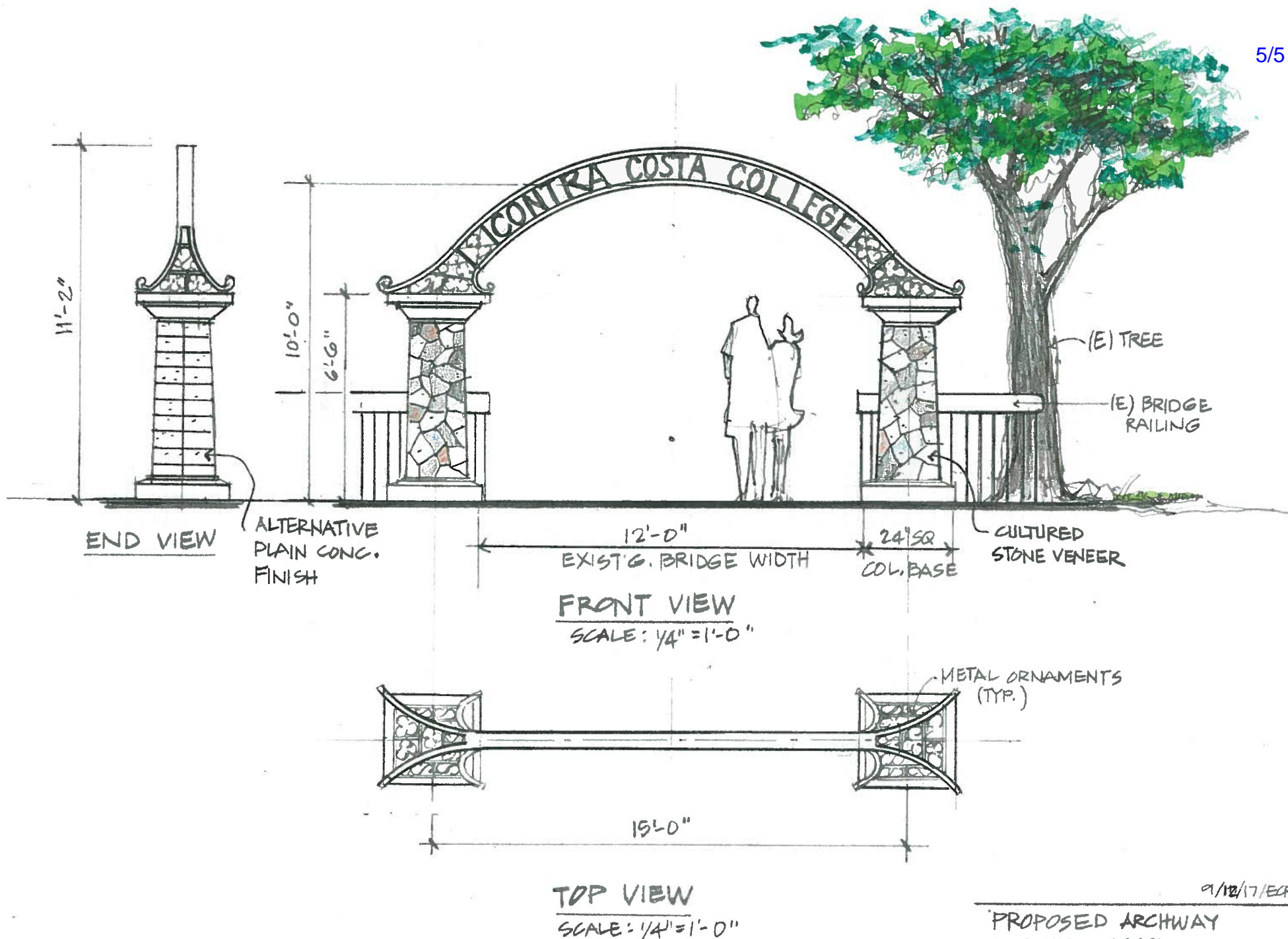

OPTION #2 WITH STONE VENEER (CAN ALSO BE WITH CONCRETE FINISH)

9/12/17/ECF
 PROPOSED ARCHWAY
 for CONTRA COSTA COLLEGE
 CAMPUS
 2600 MISSION BELL DR.

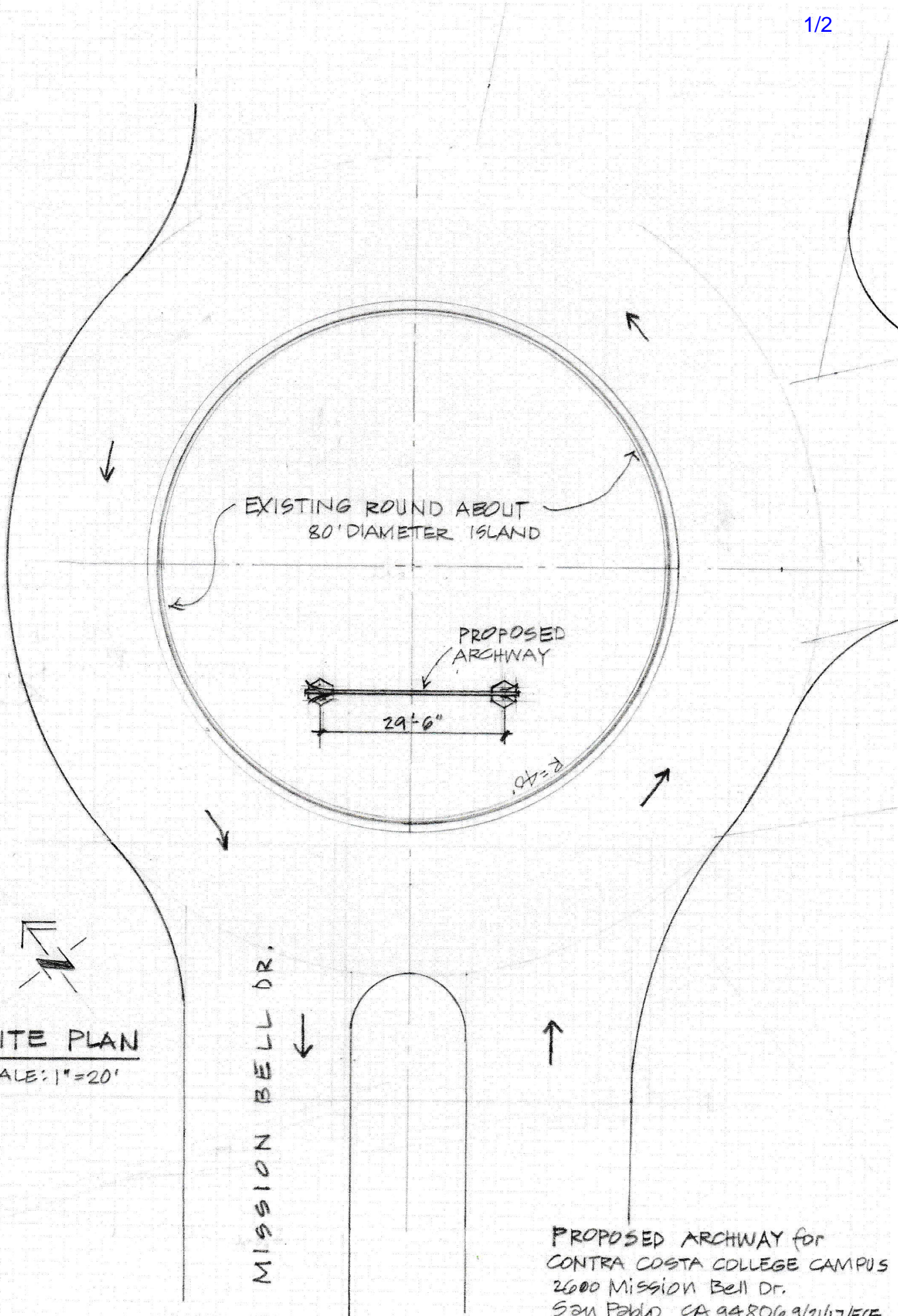

SITE PLAN
SCALE: 1"=20'

MISSION BELL DR.

PROPOSED ARCHWAY FOR
CONTRA COSTA COLLEGE CAMPUS
2600 Mission Bell Dr.
SAN PABLO, CA 94806 9/21/17/ECF
SHT. 1 OF 2



PROPOSED ARCHWAY FOR:
CONTRA COSTA COLLEGE CAMPUS
2000 MISSION BELL DR.
SAN PABLO, CA 94806 9/21/17/ECF
SHT 2 OF 2